

全国免费服务热线：
/National Free Tel

400+6572+609

乘客电梯 Passenger Elevator

German Technology

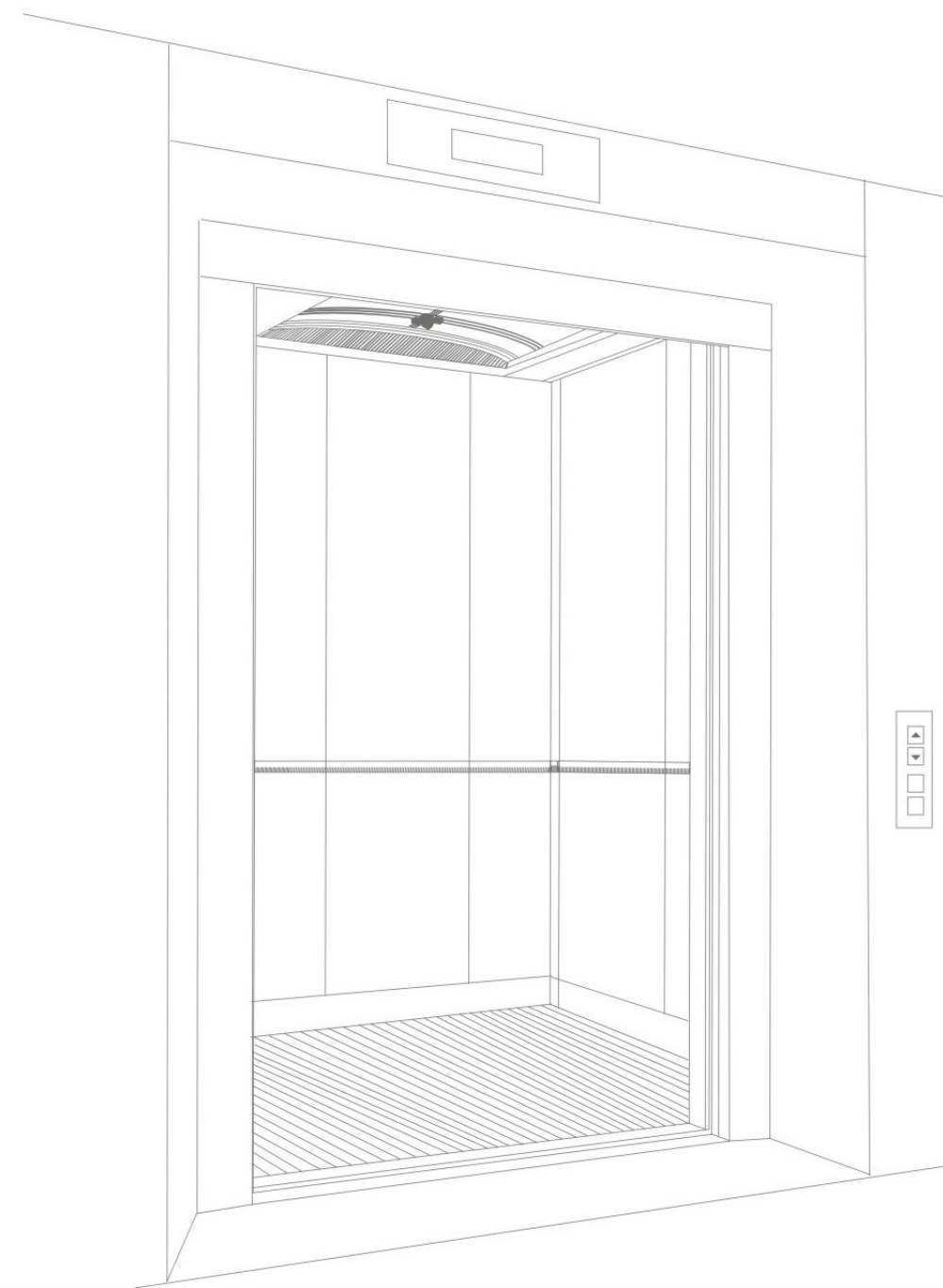

韦伯电梯有限公司
WEIBO ELEVATOR CO.,LTD

地址:浙江南浔经济开发区东翔路
Add: Dongxiang Road, Nanxun Economic Development Zone, Zhejiang Province, China

总机电话(Tel): 0572-2626611
直线电话(Tel): 0572-3033611 3033622
销售热线/传真(Fax): 0572-3033577

Http: www.weboelevator.com
E-mail: info@weboelevator.com

© 2018版(第一次印刷)
本手册为一般信息类出版物, 所示信息仅供参考。



WEBSTAR

—— 韦伯电梯 ——

国家高新技术企业

向上 为了美好生活

Up for happy life



德国技术
German Technology

Advanced Control System

核心技术

韦伯系列电梯控制柜采用德国高技术含量的部件供应商所提供之零部件整合而成，秉承了当今世界先进的电梯控制技术，包括微机串行通讯技术、矢量控制变频调速技术等。根据实际需要客户可任意配备并联、群控、远程监控等功能。同时大大减少了电缆的芯数，降低了布线成本，使电梯运行更加安全可靠。电机拖动采用VVVF系统，保证了电梯运行具有良好的舒适感。变频技术的应用，提高了电梯运行的效率，节省了能源。优良的品质，极低的故障率加上较高的性能价格比，使韦伯各系列梯种从成本开始就领先于各竞争对手，给客户以实惠。此外，运用了高性能矢量变频变压控制技术的韦伯系列控制柜，通过同时调整频率和电压，以及数字模拟的输入输出，使加减速以及平层方面更加平稳，使电梯的运行性能达到更完美。

"WEBSTAR" serial lift control cabinets apply the high technical content parts from German, French, Japanese suppliers etc. for the integration. We adhere to nowadays advanced lift control technology in the world including micro-computer serial communication technology, vector control variable frequency governor technology etc. The customers can freely allocate with parallel connection, group supervision and long-distance monitor functions and so on according to the actual needs. Meanwhile we greatly reduce the cable cores, decrease wire distribution cost and result in the more safe and reliable lift travel. The motor drive adopts VVVF system to ensure the passenger feeling comfortable in the process of running. The application of variable frequency technology increases the lift travel efficiency, saves the energy. The superior quality, extremely low trouble rate, plus high cost performance enable various WEBSTAR lifts keep ahead among numerous competitors in the aspects such as the cost etc. We grant the client with yield more substantial benefits. In addition, we utilize high performance vector variable frequency and variable voltage control technology WEBSTAR serial control cabinets to bring about the more smooth acceleration, deceleration and leveling through simultaneously adjusting the frequency, voltage, inputting and outputting digital analog. It results in the more perfect lift travel properties.



电梯控制柜

图片仅供参考，请以实物为准



● 先进的全电脑数据网络化

Advanced Fully Computerized Data Network

网络化、多模块、智能型电梯控制
Network multi-modules and intelligence control system

可视化、记录、诊断、远程访问、远程参数设置
Visualization, recording, diagnosis, remote access, remote parameterizing

可通过无线、有线和调制解调器进行远程监控
Remote monitoring via line/non-line/modem

可通过调制解调器进行召唤
Remote on demand via modem

可编程对所有系统进行循环召唤
Programmable circular call to all system

具有电梯助理功能
It is equipped with the lift assistant functions.

永恒的预防性维护
Eternal preventative maintenance

低成本的管理系统
Low cost system management

最大的安全性
Max. excellent safety

● 微电脑信号控制系统

Signal Processing System Based On Microprocessor

功能强大的双32位中央处理器，数据处理高效实时
Powerful motorola 32 bytes CPU for high efficient and real-time data processing

实现了超乎寻常的舒适感和平层精确度
As well as the perfect comfortable feel and leveling accuracy

可实现8台电梯群控
Group control up to 8 elevators

SMZ四重保护，提前开关门高效且安全
SMZ for quadruple protections, high efficient and safe door pre-opening

强大的功能满足不同用户的各种需求
Meeting a variety of demands from different customers by our complete function sets

● 数据库管理

Database Management

支持WINDOWS环境和网络操作系统NONELL\WINNT
Supporting MS WINDOWS/MS WINNT/NONELL

GSM无线远程监控功能
GSM wireless remote adjustment

先进的控制技术

High Quality Component

优质的电梯部件

韦伯各型号电梯可根据使用要求设计不同的拖动系统和曳引机，其全部技术参数均经过严格计算和匹配运行试验，做到配置合理、低耗高效、结构紧凑、外形精致，主要技术指标和安全性达到国际先进水平。

Various styles of WEBSTAR elevator have been designed with different driving systems and traction machines according to different use requirements. All the technical parameters have been strictly calculated and matched for the running test. It fulfills the reasonable collocation, low loss, high effectiveness, compact structure, fine and exquisite outline. The major technical indexes, safety and reliability reach to the international advanced level.

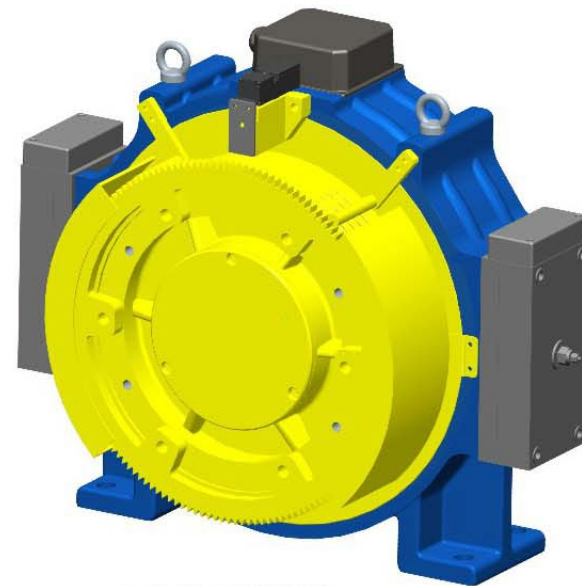

永磁同步无齿轮曳引机

● 永磁同步无齿轮曳引机

Gearless Traction Machine

节省能源

Energy-saving

热量散失低，运行成本最小，工作效率高达95%。与一般的传统技术相比，能源节省40%。

Low heat loss, min. running cost, the work efficiency can be as high as 95%. It saves 40% of the energy compared with the ordinary traditional technology.

运行平稳

Smooth running

高精度制造，运行特别平稳，舒适感特别好。与精确速度控制和全控式闭环回路VVVF驱动系统相结合，可使停层非常准确，启动和停止十分平稳。

High precision of the precision speed control and fully controlled closed loop drive system brings about very accurate landing and rather smooth start/stop. The most optimized combination between VVVF frequency converter and gearless traction machine

坚固耐用

Firm and durable

采用了最高的设计标准。活动零件数量限为最少，从而保证了设备可靠性和持续的良好性能，可使停层非常准确，启动和停止十分平稳。

The combination of the precision speed control and fully controlled loop drive system brings about very accurate landing and rather smooth start/stop. The most optimized combination between VVVF frequency converter and gearless traction machine.

绿色环保免维护

Environmental protection, maintenance-free

由于无齿轮曳引机无需复杂的润滑系统，彻底解决了传统曳引机漏油造成的环境污染问题，达到电机的免维护及环保要求。

As the construction of gearless traction machine needs no complicated lubricating system, it thoroughly solves the environmental pollution caused by oil leakage from the traditional traction machines. It fulfills non-maintenance of the motors and the environmental protection demands as well.

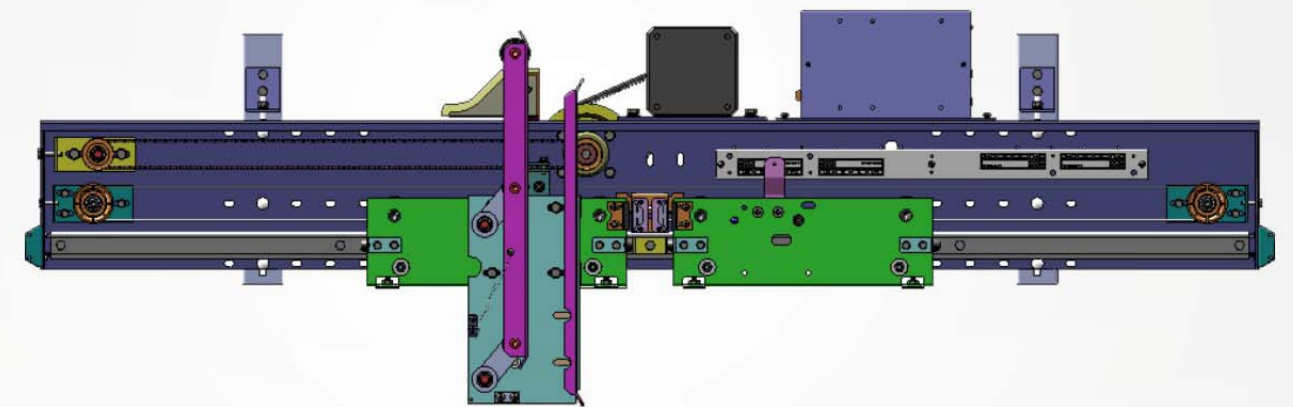

● VVVF 变频门机

VVVF Variable Frequency Door Motor

将先进的VVVF 变压变频控制技术运用到自主研发的电梯门机系统，确保门流畅和宁静开关，提高电梯门开关的灵敏并自动调整每个楼层最适合的开关以确保安全可靠。而且有自学习能力的门负载检测器，更加提高了梯门开关的灵敏度，监控每个楼层梯门负载的变化，当受到异常阻力时梯门会自动重新打开。

It utilizes the advanced VVVF variable voltage & variable frequency control technology to the lift door machine system so as to ensure the smooth lift door and the quiet switch. It enhances the sensitivity of the lift door switch and automatically regulates the most proper switch speed in every floor to guarantee the fine security and reliability. And the self-study door load detector further improve the sensitivity of the lift door switch. It monitors the lift door load variation of each floor. When it encounters the abnormal resistance, it will re-open the lift door.

● 高效矢量VVVF 变频器

Effective Vector VVVF Frequency Converter

韦伯电梯采用矢量控制的数字闭环VVVF变频器，可根据轿厢的实际负载，上下行速度，通过对流大小和相位的调整，实时精确控制主机转动力矩，平稳地加速或减速，运行舒适性近乎完美。

WEBSTAR lift adopts the vector-controlled digital closed loop VVVF frequency inverter. It can accurately and real-time control the rotative moment or traction machine through adjusting the current and phase according to the actual car load and up/down speed. It can smoothly accelerate or decelerate with comfortable travel.



● 光幕保护

Optical Curtain Protection

韦伯电梯，利用反应可靠的机械式挡板和灵敏密集的红外光幕，在电梯门口形成光幕屏障，对于任何进入其探测平面的人或物体都能做出灵敏的反应，安全性能高，不必担心传统门触板对人或物体的碰触，以免造成不必要的伤害。

WEBSTAR lift has a reliably-reacting mechanical hood and the sensitive and concentrated optical curtain that constitutes an optical curtain shield at the lift door to sensitively react to any about the strike of passengers' heads or other objects on the door edge that many occur to a traditional lift door. So that accidental injuries to passengers are prevented.

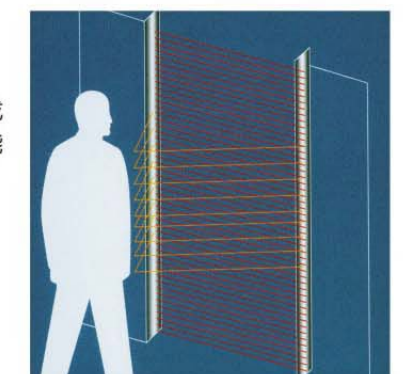

优越性能 The Advantageous Performances



WEBSTAR



现代的中、高层大楼需要对建筑内的人流流量进行有效的管理。无论是停车场、饭店、咖啡店、健身房以及会议厅都对建筑内的人流流量控制有各自的要求。韦伯可以运用多种先进的管理工具，在您大楼交通流量规化的初期为您出谋划策，使运行在您大楼内的电梯实现其最佳的交通流量处理能力，并且高效节能。

Modern medium to high-rise towers need efficient people flow solutions. Car parks, restaurants, coffee shops, gymnasiums meeting rooms, and conference halls all make demands on the people flow solution. WEBSTAR offers assistance in traffic planning from the Very early stages and has many tools to maximize the traffic performance of the elevators in the building, with energy saving solution.

安全 Secure

系统通过串行传输线连接数台微处理器，确保了高可靠性。在各微处理器间，配置有诊断程序，并设置备份系统，进一步提高了系统可靠性和乘客的安全性。

The system connects the multiple micro-processors through serial transmission lines. It ensures its high reliability. It matches with diagnostic program between various micro-processors. It sets backup system to further enhance the systematic reliability and the passenger's security.

舒适 Comfortable

平滑的速度调节，极高的可靠性和稳定性，拥有实用、安全、方便的各种功能。

It owns the smooth speed regulation, extremely high reliability and stability, various safe; practical and convenient functions.

高效 Effective

在韦伯电梯系列的数据网络系统中，微处理器遍布于电梯结构内，以实现对整个系统进行更高效的控制，每台微处理器专门设计有推理能力，极大地扩展了“梯界面”。

In data network system of WEBSTAR elevator series, micro-processors are wide-spreading in the elevator structures. In order to fulfill the more effective control to the whole system, every micro-processor specially designs the reasoning ability. It largely extends the "elevator interface".

节能 Energy-saving

节能比一般的电梯节省电力达40%以上，高效率、低噪音的驱动主机，降低电力供电容量，节省用户成本。

It saves over 40% of energy than that of ordinary elevators. The effective and low-noise drive host reduces power-supply capacity, saves the user's cost.

灵活 Flexible

数据网络处理器的分散配置，令系统的功能和操作更加简单化，从而能随时迎合大楼和用户不断的需求。

The disperse configuration of data network processor brings about the simpler systematic functions and operations. Therefore it can meet the requirements from vast users and buildings at any time.

智能 Intellectual

韦伯电梯不仅采用一体化智能控制系统，且可选用智能IC卡管理、远程监控、上下班高峰智能系统等多项技术运用，可谓卓尔不群的智慧型电梯。

WEBSTAR elevator option the multiple technological applications such as the integrated intellectual control system, intellectual IC card management, long-distance monitor, peak-hour intellectual system etc. It has been reputed as a true and distinguished intelligent elevator.



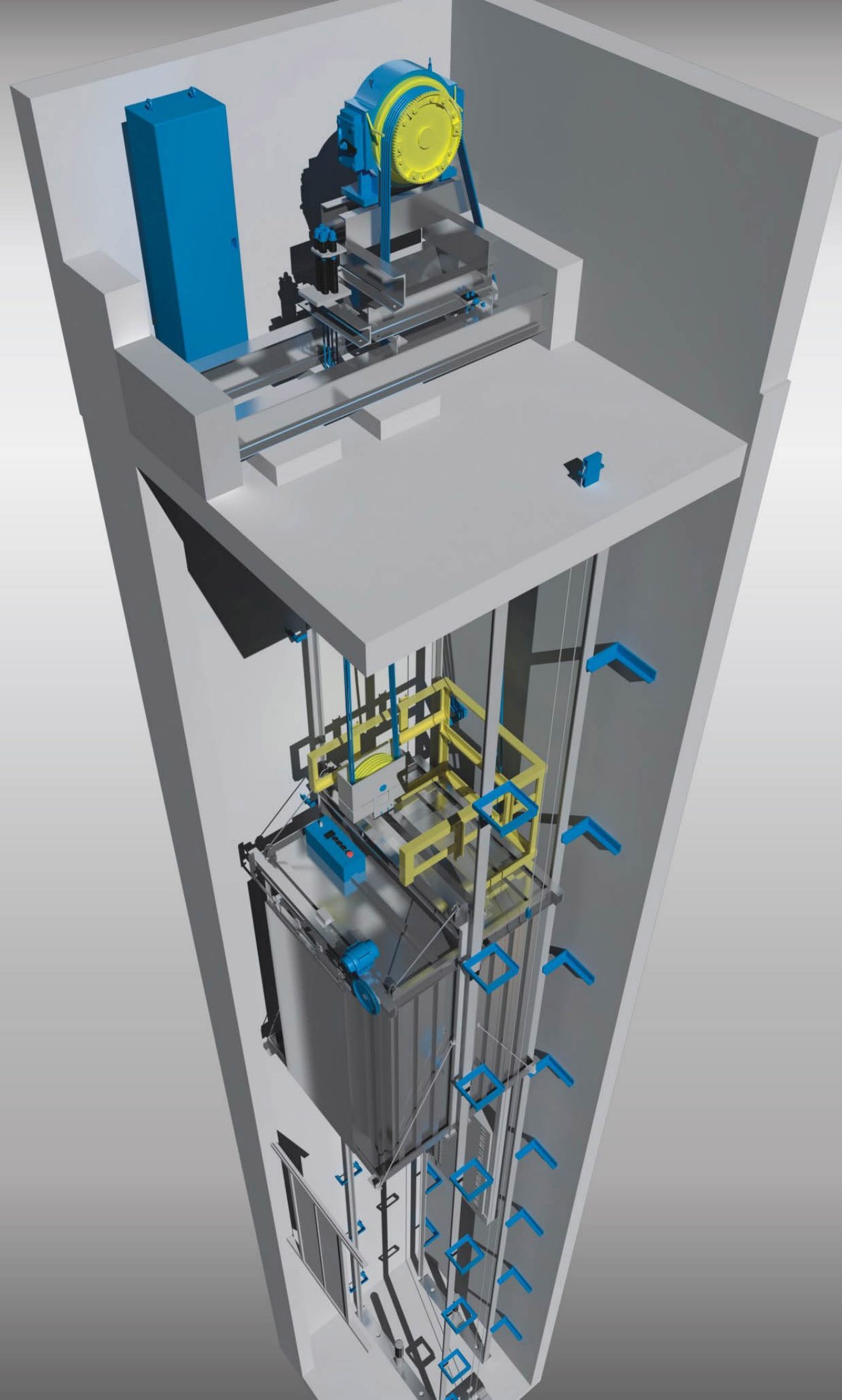

小机房电梯

Small Machine Room Elevator

韦伯小机房电梯在现代高度成熟技术的基础上，提升了电梯系统的可靠性与灵活性，实现了真正的环保与节能的优势。采用新型的永磁同步无齿轮曳引机，大大提高了曳引机的效率，降低了能源消耗。

该系列电梯以其节能环保有效节省空间及降低建造和运行成本的优势著称，集优良的配置、精湛的设计、豪华大方的装饰于一身，广泛应用于住宅、办公、宾馆和公共建筑等场所。

On the basis of the highly mature technology in the modern times, WEBSTAR small machine room elevator elevates the reliability and flexibility of the lift system. It fulfills the advantage of the true environmental protection and the energy-saving. It uses the novel permanent magnet synchronous gear-less traction machine which largely lifts up the efficiency of the traction machine and lowers down the energy loss.

This series elevator is famous for its sound energy & space saving, the fine environmental protection and its low building g and running cost. It integrates the superior allocations, the consummate design and the elegant and deluxe decoration into a whole. It is widely applicable for the residence, office buildings, hotels and the public construction etc.



绿色环保

Green environmental protection

主机采用封闭式承载结构，全密封式轴承无需更润滑油脂，在实现免维护的同时完全免除了油渍的污染；

The dispatch adopts the enclosed bearing structure. The air-tight bearing needs no renewal of the lubricating grease. At the same time of fulfilling the maintenance-free, it completely avoids the oil-stained pollution.

高效节能

Highly efficient and energy-saving

主机无需励磁，启动电流极小、传动效率极高，故与传统曳引机相比，节能效果高达30%以上，显著地降低了电梯日常使用成本；

The dispatcher needs no excitation with the extremely little starting current and very high drive efficiency. Therefore compared with the traditional traction machine, it can get above 30% higher of the energy-saving effect. It obviously decreases the daily use cost of the elevators.

节省空间

Space-saving

因主机结构紧凑、轻盈小巧，故可根据用户的需求选择极其紧凑的机房布局（小机房）或直接将主机安装在井道内（无机房），最大程度节省建筑面积与费用。

Because of the small, compact, exquisite structure of the dispatcher, it can choose the extremely compact machine room layout (small machine room) or directly install the dispatcher in the well (machine room-less) according to the user's requirements. It saves the construction area and expense to the greatest extent.

WP175 Passenger Elevator

WP175乘客电梯



Standard Configuration WP175标准配置



COP-01
(标配 standard)

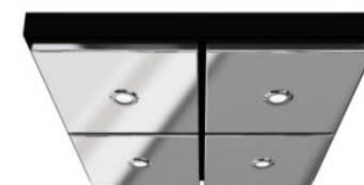

CL-01(一体式) (标配 standard)

一体式吊顶，标配LED筒灯，镜面不锈钢。

Integrated ceiling, Standard LED lamp, Mirror stainless steel.



仅供参考，以实物为准
This is for reference only.
Please take actual products as criterion

轿壁材料 Wall material

标准喷涂钢板，颜色可选。

WP175

目标市场 Target Market	普通住宅、宾馆等 Ordinary residential, hotels, etc.
控制系统 Control System	VVVF
曳引机 Traction machine	无齿轮 Gearless
门机 Door machine	VVVF 变频门机 VVVF Variable Frequency Door Motor
轿厢高度 Car height	2400mm
额定载重 (公斤) Rated Load(kg)	630、800、1000
额定速度 (米/秒) Rated Speed(m/s)	1.0、1.5、1.75
最大提升高度 (米) Max.Travel Height	50、75、90
最大群控台数 Max.Car Group	8

Construction Parameters 土建参数

WP175 紧凑型住宅电梯 WP175 Compact Residence

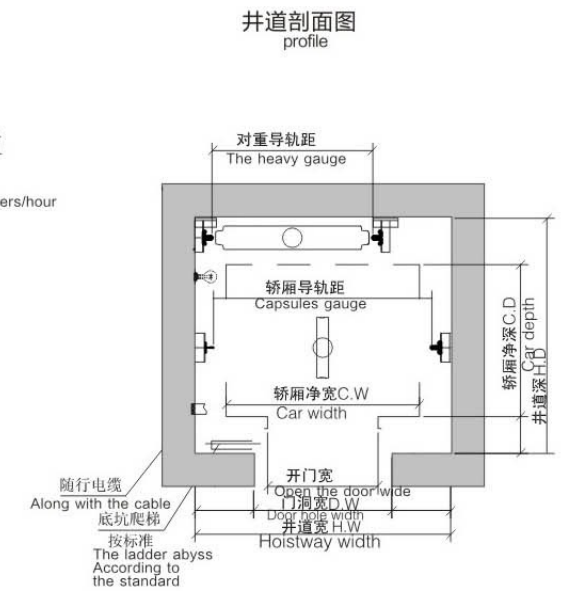
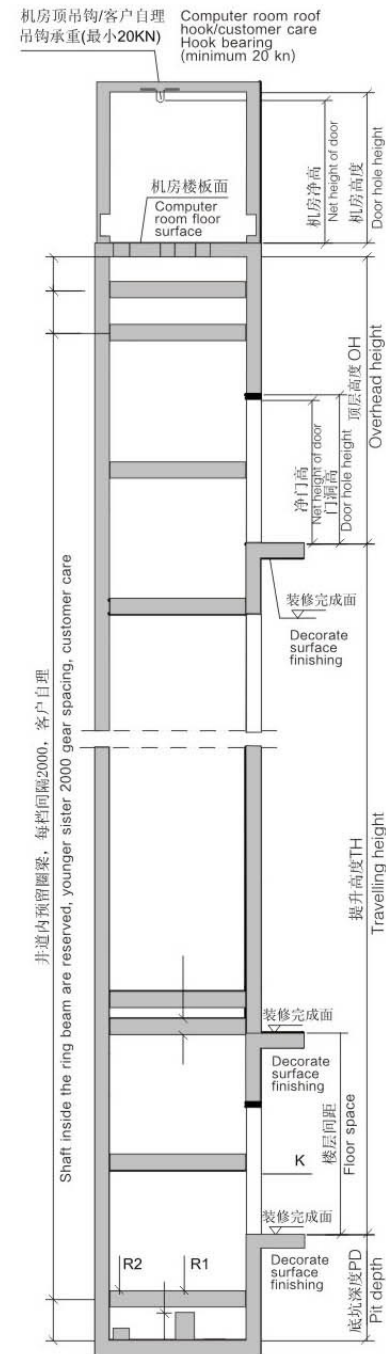
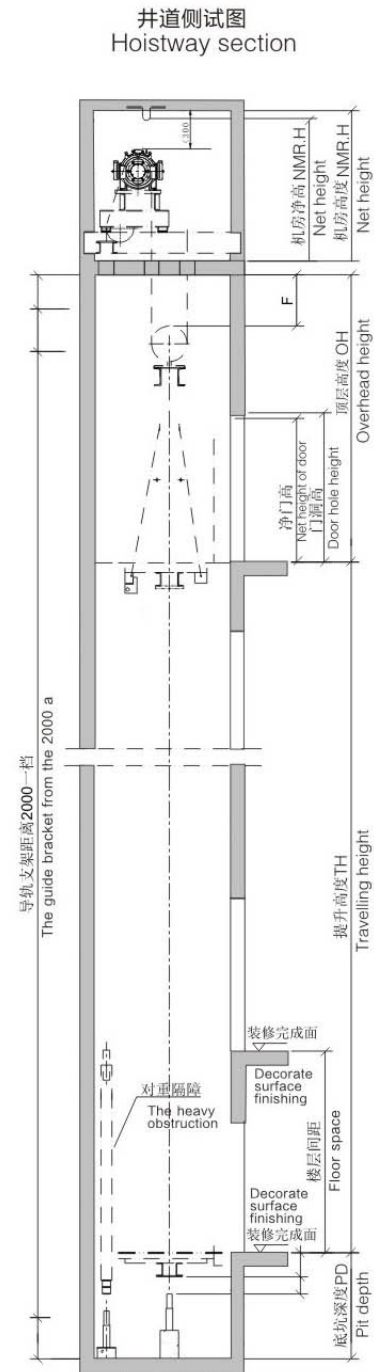

主要参数 Main specifications	载重量(Kg) Loading capacity	630			800			1000		
	额定速度(m/s) Rated speed	1	1.5	1.75	1	1.5	1.75	1	1.5	1.75
轿厢尺寸(mm) Car size	宽 Width	1400	1400	1400	1400	1400	1400	1600	1600	1600
	深 Depth	1100	1100	1100	1350	1350	1350	1400	1400	1400
	高 Height	2400	2400	2400	2400	2400	2400	2400	2400	2400
开门尺寸(mm) Door opening size	宽 Width	800	800	800	800	800	800	900	900	900
	高 Height	2100	2100	2100	2100	2100	2100	2100	2100	2100
井道尺寸(mm) Hoistway size	宽 Width	1900	1900	1900	1950	1950	1950	2100	2100	2100
	深 Depth	1700	1700	1700	1950	1950	1950	2000	2000	2000
对重位置 Counterweight position		后	后	后	后	后	后	后	后	后
最大提升高度(m) Max travelling height		50	75	90	50	75	90	50	75	90
底坑深度(mm) Fit depth		1500	1600	1700	1500	1600	1700	1500	1600	1700
顶层高度(mm) Top floor height		4500	4600	4700	4500	4600	4700	4500	4600	4700
机房高度(mm) Machine room height		2500	2500	2500	2500	2500	2500	2500	2500	2500
曳引比 Roping		2:1	2:1	2:1	2:1	2:1	2:1	2:1	2:1	2:1

注：土建及参数表仅供参考。Note: Construction layout and parameters are for reference only.



乘客电梯 Passenger Elevator

韦伯系列乘客电梯利用国外先进的电梯控制技术，通过吸收、转化、提升而生产出的系列新型全电脑、模块化控制的变频调速电梯，其先进的变频(VVVF)驱动和全电脑控制技术，融合了数据网络化系统和模块化结构，使系统控制更加精确、高效、灵活、合理，并利用最有效的自检程序，使电梯能淋漓尽致地发挥其功效，将电梯的性能提高到一个更高的水平，真真切切的满足乘客的要求。

韦伯系列乘客电梯其轿厢设计灵活多样，能与多种建筑物融为一体，尤其适合日益增长的中高层建筑的需求。是宾馆、饭店、办公大楼、商住楼、娱乐中心、商场等场所最为理想的选择。

韦伯以自己的品质保证：一个优秀的电梯系统会使您的建筑生机勃勃，使您更享与众不同的尊贵和豪华。

"WEBSTAR" serial passenger lift utilizes the advanced lift control technology from the overseas countries. We absorb, transform, and improve this technology, and manufacture series of late-model fully computerized and modularized control VVVF passenger lift. Its advanced variable frequency(VVVF) drive and fully computer control technology merges with the data net system and modularized structure. It brings about a more precise, efficient, flexible and reasonable systematic control. It also adopts the most effective self-inspection program to give a full play of the lift functions. It moves the lift performance to a higher level. It truly satisfies the passenger is requirements.

"WEBSTAR" serial passenger lift has flexible and Varied car design. It can integrate with multiple constructions into a whole. It is especial-t fit for the demands from the rapidly increasing from medium and high rise buildings. It is the most idea. I choice for the guest-house, restaurant, office building, commercial and residential building, recreation center, shopping center etc.

"WEBSTAR" lift guarantees on behalf of its own quality, "an excellent lift system can bring full of vitality to your constructions. what is more, you can enjoy the extraordinary honor and luxury"

WP40 Standard Configuration WP40 标准配置

仅供参考，以实物为准
This is for reference only.
Please take actual products as criterion



COP-11
(标配 standard)



CL-02(一体式)
(标配 standard)

镜面不锈钢框架，中间亚克力灯源，两侧LED筒灯。

Mirror finished stainless steel framework, middle acrylic lighting source, both sides of LED lamps

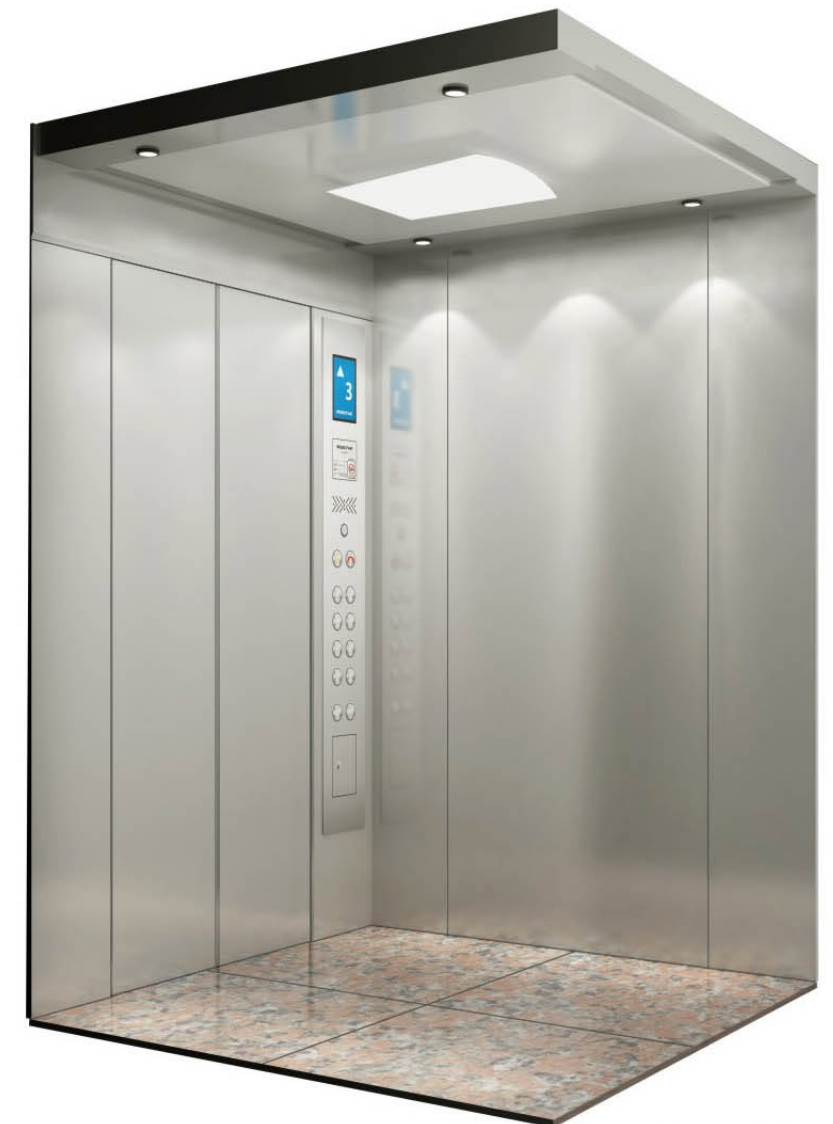

WP40 乘客电梯技术规格表
passenger lift technical specification table

目标市场 Target Market	中高档住宅、商务楼、酒店 The high-end residential, commercial buildings, hotels
控制系统 Control System	VVVF
曳引机 Traction machine	无齿轮 Gearless
门机 Door machine	VVVF 变频门机 VVVF Variable Frequency Door Motor
轿厢高度 Car height	标配: 2400mm 选配: 2500mm, 2600mm
额定载重 (公斤) Rated Load(kg)	450, 630, 800, 1000, 1150, 1250, 1350, 1600
额定速度 (米/秒) Rated Speed(m/s)	1.0, 1.5, 1.75, 2.0, 2.5
最大提升高度 (米) Max. Travel Height	125
最大群控台数 Max. Car Group	8

吊 顶: CL-02一体式(标配)	Ceiling: CL-02 Integrated Ceiling(Standard)
操纵箱: COP-11(标配)	Operation panel: COP-11(standard)
轿 壁: 发纹不锈钢板	Car wall: Hairline stainless steel plate
轿 门: 发纹不锈钢板	Car door: Hairline stainless steel plate
地 板: PVC塑胶地板	Floor: PVC plastic cement floor

Construction Parameters 土建参数

WP40 标准型乘客电梯 (商用) WP40 Standard Passenger Elevator (for business)

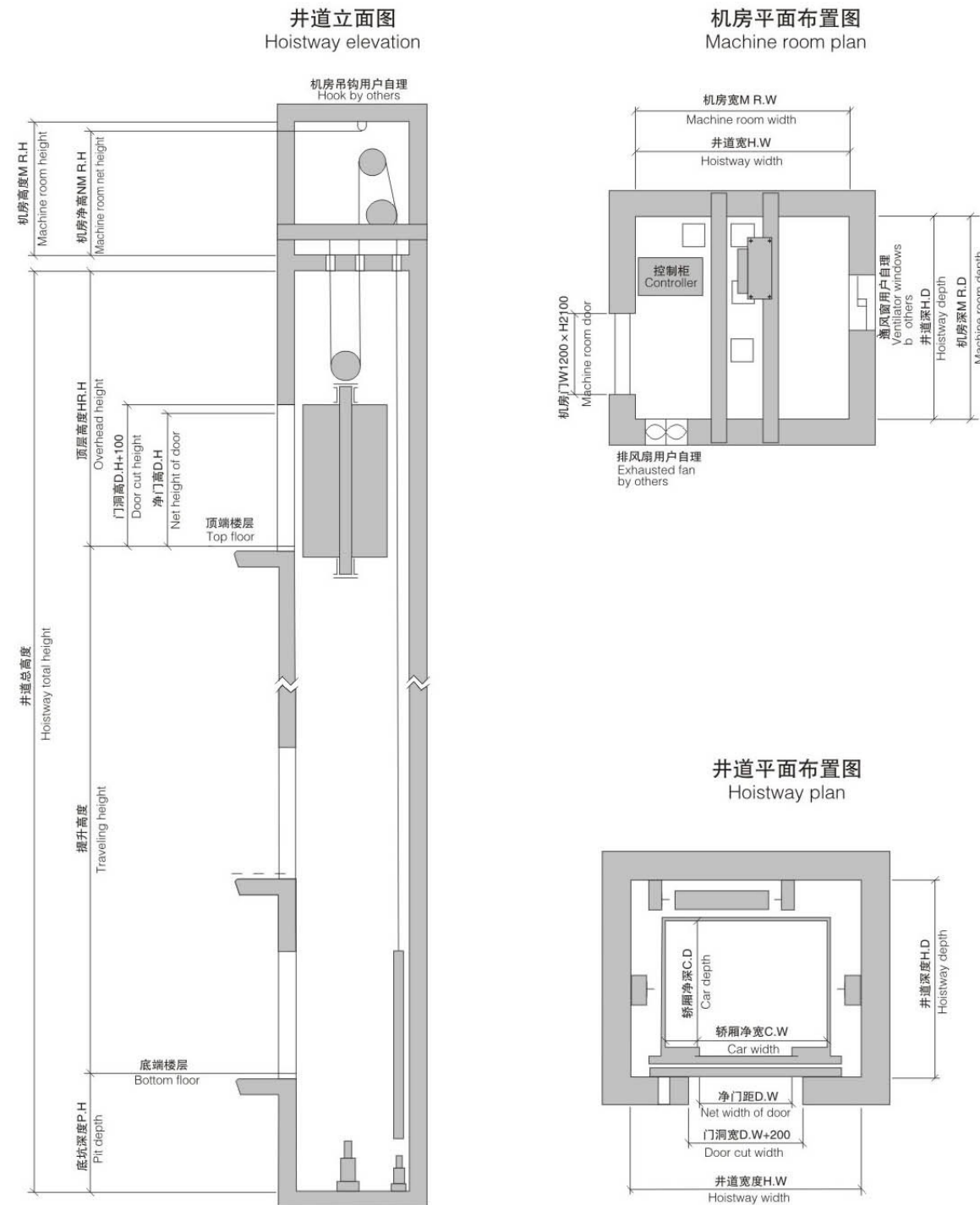

◎小机房电梯 (一) Small Machine Room Elevator(1)

主参数 Main specifications	载重量(Kg) Loading capacity		450			630			800			1000				
	额定速度(m/s) Rated speed		1	1.5	1.5	1.5	1.75	1	1.5	1.75	2	2.5	1	1.5	1.75	2
轿厢尺寸(mm) Car size	宽 Width	1100	1100	1400	1400	1400	1400	1400	1400	1400	1400	1600	1600	1600	1600	1600
	深 Depth	1000	1000	1100	1100	1100	1350	1350	1350	1350	1350	1400	1400	1400	1400	1400
	高 Height	2400	2400	2400	2400	2400	2400	2400	2400	2400	2400	2400	2400	2400	2400	2400
开门尺寸(mm) Door opening size	宽 Width	700	700	800	800	800	800	800	800	800	800	900	900	900	900	900
	高 Height	2100	2100	2100	2100	2100	2100	2100	2100	2100	2100	2100	2100	2100	2100	2100
	方式 Mode	中分	中分	中分	中分	中分	中分	中分	中分	中分	中分	中分	中分	中分	中分	中分
井道尺寸(mm) Hoistway size	宽 Width	1700	1700	2000	2000	2000	2000	2000	2000	2000	2000	2200	2200	2200	2200	2200
	深 Depth	1650	1650	1750	1750	1750	2000	2000	2000	2000	2000	2050	2050	2050	2050	2050
对重位置 Counterweight position		后	后	后	后	后	后	后	后	后	后	后	后	后	后	后
最大提升高度(m) Max travelling height		50	75	50	75	90	50	75	90	100	125	50	75	90	100	125
底坑深度(mm) Pit depth		1500	1600	1500	1600	1700	1500	1600	1700	1800	1900	1500	1600	1700	1800	1900
顶层高度(mm) Top floor height		4500	4600	4500	4600	4700	4500	4600	4700	4800	5100	4500	4600	4700	4800	5100
曳引比 Roping		2:1	2:1	2:1	2:1	2:1	2:1	2:1	2:1	2:1	2:1	2:1	2:1	2:1	2:1	2:1

◎小机房电梯 (二) Small Machine Room Elevator(2)

主参数 Main specifications	载重量(Kg) Loading capacity		1150					1250					1350					1600				
	额定速度(m/s) Rated speed		1	1.5	1.75	2	2.5	1	1.5	1.75	2	2.5	1	1.5	1.75	2	2.5	1	1.5	1.75	2	2.5
轿厢尺寸(mm) Car size	宽 Width	1700	1700	1700	1700	1700	1950	1950	1950	1950	1950	1950	1950	1950	1950	1950	1950	1950	1950	1950	1950	
	深 Depth	1500	1500	1500	1500	1500	1400	1400	1400	1400	1400	1500	1500	1500	1500	1500	1750	1750	1750	1750	1750	
	高 Height	2400	2400	2400	2400	2400	2400	2400	2400	2400	2400	2400	2400	2400	2400	2400	2400	2400	2400	2400	2400	
开门尺寸(mm) Door opening size	宽 Width	1000	1000	1000	1000	1000	1000	1000	1000	1000	1000	1000	1000	1000	1000	1000	1000	1000	1000	1000	1000	
	高 Height	2100	2100	2100	2100	2100	2100	2100	2100	2100	2100	2100	2100	2100	2100	2100	2100	2100	2100	2100	2100	
	方式 Mode	中分	中分	中分	中分	中分	中分	中分	中分	中分	中分	中分	中分	中分	中分	中分	中分	中分	中分	中分	中分	
井道尺寸(mm) Hoistway size	宽 Width	2300	2300	2300	2300	2300	2600	2600	2600	2600	2600	2600	2600	2600	2600	2600	2600	2600	2600	2600		
	深 Depth	2150	2150	2150	2150	2150	2100	2100	2100	2100	2100	2300	2300	2300	2300	2300	2550	2550	2550	2550	2550	
对重位置 Counterweight position		后	后	后	后	后	后	后	后	后	后	后	后	后	后	后	后	后	后	后	后	
最大提升高度(m) Max travelling height		50	75	90	100	125	50	75	90	100	125	50	75	90	100	125	50	75	90	100	125	
底坑深度(mm) Pit depth		1500	1600	1700	1800	1900	1500	1600	1700	1800	1900	1500	1600	1700	1800	1900	1500	1600	1700	1800	1900	
顶层高度(mm) Top floor height		4500	4600	4700	4800	5100	4500	4600	4700	4800	5100	4500	4600	4700	4800	5100	4500	4600	4700	4800	5100	
曳引比 Roping		2:1	2:1	2:1	2:1	2:1	2:1	2:1	2:1	2:1	2:1	2:1	2:1	2:1	2:1	2:1	2:1	2:1	2:1	2:1	2:1	

注：土建及参数表仅供参考。Note: Construction layout and parameters are for reference only.

无机房电梯

Machine Roomless Elevator

韦伯无机房电梯产品采用目前世界上最为先进的永磁同步无齿轮曳引技术、结合全微机智能控制系统和电梯专用型VVVF变频器的使用,令该系列产品具备绿色环保、高效节能、节省空间、安全舒适等卓越性表现。

该系列产品可广泛应用于中低层住宅、宾馆商务写字楼等,全面满足日常输送客户的需求。

WEBSTAR machine-roomless elevator adopts the most advanced permanent magnet synchronous and gearless traction technology in the world. It combines with the use of all micro-computer intellectual control system and lift special-purpose VVVF variable frequency. As a result, the series goods are equipped with the outstanding features of green environmental protection, highly effective energy and space saving secure and comfortable etc.

The series products can be widely applicable for the low-rise residence, hotel and business office building etc. It comprehensively satisfies the requirements for the daily transport passengers.



控制系统

Control system

引进德国技术的高集成度32位全数字式微机控制系统,具有完善的功能配置、快捷的数据处理与实时响应能力、更强的抗干扰能力。

It introduces the highly integrated 32-digit fully numeric micro-computer control system with the German technology. It has the perfect functional allocations, the prompt data processing and real-time responsive capacity, the stronger anti-interference abilities.



矢量变频技术

Vector variable-frequency technology

根据轿厢的实际负载、上下行速度、通过对电流大小和相位的调整,实时精确控制主机转动力矩,确保电梯运行状态平稳。

To control the rotating moment of the mainframe precisely and in time according to the actual load of the cars and upper and lower speed acceleration, and by adjusting the electric currents and phases, so as to ensure the stable operation of the elevators.

高精度编码器

High precision encoder

性能及控制精度远远高于传统有齿轮电梯使用的增量编码器,电梯启动干净利落、加速平稳、停止位置准确。

Their performance and control precision far exceed those of the incremental encoders used by the traditional gear elevators. The elevators can start quickly with stable acceleration and accurate stopping position.

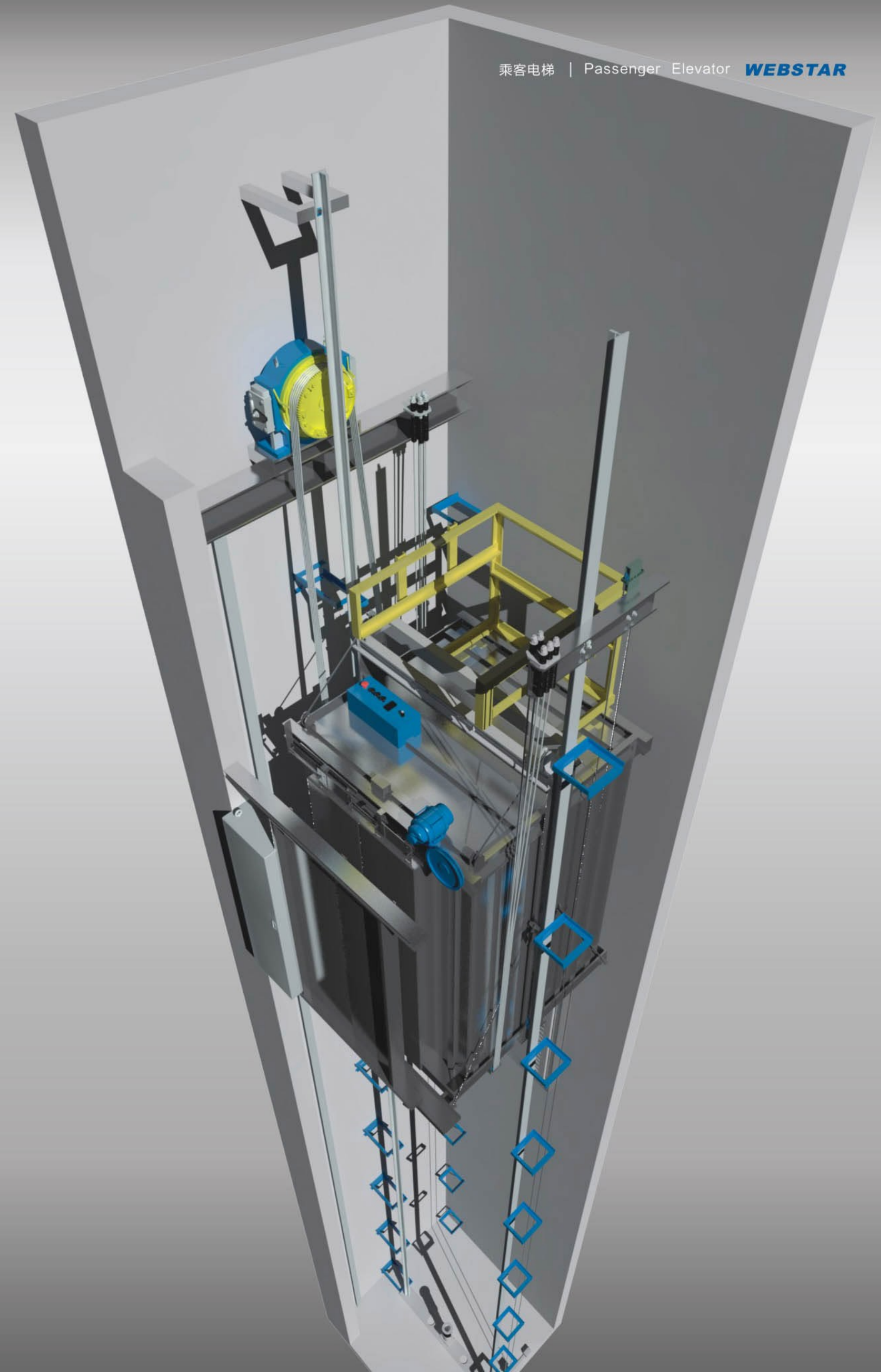

Construction Parameters 土建参数

WPN30 无机房电梯 (乘客、住宅)
WPN30 Machine-roomless Elevator/Passenger (for residence)

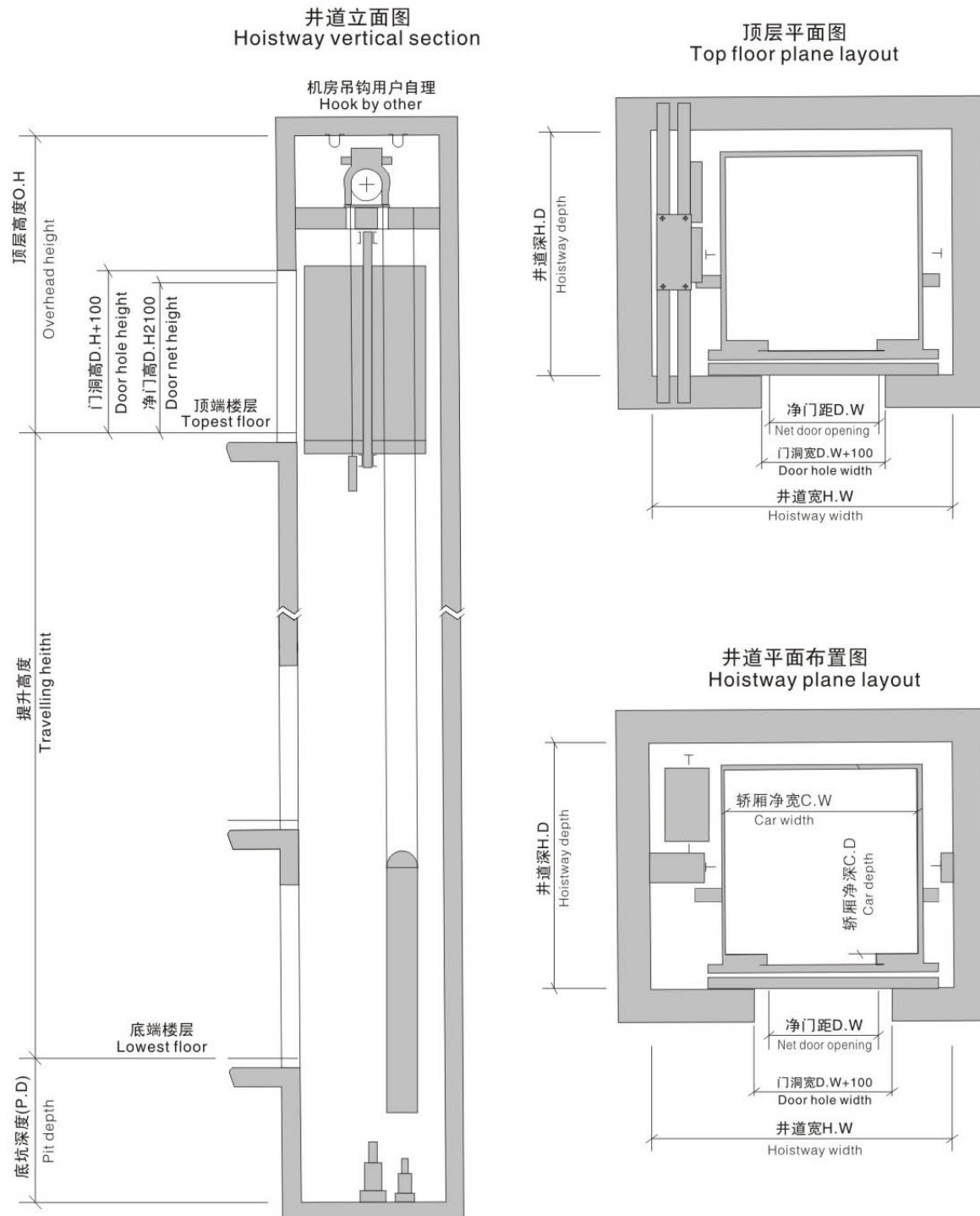

◎无机房电梯 Machine Roomless Elevator

载重量(Kg) Loading capacity		450			630			800					1000				
额定速度(m/s) Rated speed		1	1.5		1	1.5	1.75	1	1.5	1.75	2	2.5	1	1.5	1.75	2	2.5
轿厢尺寸(mm) Car size	宽 Width	1000	1000		1100	1100	1100	1400	1400	1400	1400	1400	1600	1600	1600	1600	1600
	深 Depth	1100	1100		1400	1400	1400	1350	1350	1350	1350	1350	1400	1400	1400	1400	1400
开门尺寸(mm) Door opening size	宽 Width	700	700		800	800	800	800	800	800	800	800	900	900	900	900	900
	高 Height	2100	2100		2100	2100	2100	2100	2100	2100	2100	2100	2100	2100	2100	2100	2100
井道尺寸(mm) Hoistway size	宽 Width	1850	1850		2000	2000	2000	2200	2200	2200	2200	2200	2450	2450	2450	2450	2450
	深 Depth	1700	1700		1850	1850	1850	1800	1800	1800	1800	1800	1900	1900	1900	1900	1900
对重位置 Counterweight position	方式 Mode	左	左		左	左	左	左	左	左	左	左	左	左	左	左	左
最大提升高度(m) Max travelling height		50	75		50	75	90	50	75	90	100	125	50	75	90	100	125
底坑深度(mm) Pit depth		1500	1600		1500	1600	1700	1500	1600	1700	1800	1900	1500	1600	1700	1800	1900
顶层高度(mm) Top floor height		4100	4300		4100	4300	4500	4100	4300	4500	4600	4800	4100	4300	4500	4600	4800
曳引比 Roping		2:1	2:1		2:1	2:1	2:1	2:1	2:1	2:1	2:1	2:1	2:1	2:1	2:1	2:1	2:1

载重量(Kg) Loading capacity		1150					1250					1350					1600				
额定速度(m/s) Rated speed		1	1.5	1.75	2	2.5	1	1.5	1.75	2	2.5	1	1.5	1.75	2	2.5	1	1.5	1.75	2	2.5
轿厢尺寸(mm) Car size	宽 Width	1500	1500	1500	1500	1500	1500	1500	1500	1500	1500	1950	1950	1950	1950	1950	1950	1950	1950	1950	1950
	深 Depth	1700	1700	1700	1700	1700	1900	1900	1900	1900	1900	1500	1500	1500	1500	1500	1700	1700	1700	1700	1700
开门尺寸(mm) Door opening size	宽 Width	1000	1000	1000	1000	1000	1000	1000	1000	1000	1000	1000	1000	1000	1000	1000	1000	1000	1000	1000	1000
	高 Height	2100	2100	2100	2100	2100	2100	2100	2100	2100	2100	2100	2100	2100	2100	2100	2100	2100	2100	2100	2100
井道尺寸(mm) Hoistway size	宽 Width	2400	2400	2400	2400	2400	2400	2400	2400	2400	2400	2900	2900	2900	2900	2900	2900	2900	2900	2900	2900
	深 Depth	2100	2100	2100	2100	2100	2350	2350	2350	2350	2350	2100	2100	2100	2100	2100	2400	2400	2400	2400	2400
对重位置 Counterweight position	方式 Mode	左	左	左	左	左	左	左	左	左	左	左	左	左	左	左	左	左	左	左	左
最大提升高度(m) Max travelling height		50	75	90	100	125	50	75	90	100	125	50	75	90	100	125	50	75	90	100	125
底坑深度(mm) Pit depth		1500	1600	1700	1800	1900	1500	1600	1700	1800	1900	1500	1600	1700	1800	1900	1500	1600	1700	1800	1900
顶层高度(mm) Top floor height		4100	4300	4500	4600	4800	4100	4300	4500	4600	4800	4100	4300	4500	4600	4800	4100	4300	4500	4600	4800
曳引比 Roping		2:1	2:1	2:1	2:1	2:1	2:1	2:1	2:1	2:1	2:1	2:1	2:1	2:1	2:1	2:1	2:1	2:1	2:1	2:1	2:1

注：土建及参数表仅供参考。Note: Construction layout and parameters are for reference only.



Standard Configuration 标准配置

仅供参考，以实物为准
This is for reference only.
Please take actual products as criterion

观光电梯技术规格表
Observation lift technical specification table

目标市场 Target Market	商场、办公楼、景点、酒店等 The shopping mall, office building, scenic spot, hotel etc.
控制系统 Control System	VVVF
曳引机 Traction machine	无齿轮 Gearless
门机 Door machine	VVVF 变频门机 VVVF Variable Frequency Door Motor
轿厢高度 Car height	标配: 2400mm 选配: 2500mm, 2600mm
额定载重 (公斤) Rated Load(kg)	630, 800, 1000, 1150, 1250, 1350
额定速度 (米/秒) Rated Speed(m/s)	1.0, 1.5, 1.75
最大提升高度 (米) Max.Travel Height	90
最大群控台数 Max.Car Group	8



GJ-01 (标配)

上下罩: 钢板烤漆
观光壁: 180度圆形, 安全夹胶玻璃(3块)
装饰顶: 镜面不锈钢框架, 亚克力拱形顶板
轿壁: 发纹不锈钢
扶手: Φ25不锈钢双管
地板: PVC地板

GJ-01 (standard)

Car cover: Steel plate baking finish
Observation wall: Semicircle, Glue glass of safety clamp, glass thickness 6+6
Decoration roof: Mirror stainless steel framework, acrylic arch top plate
Car wall: Hairline stainless steel
Handrail: Φ25 stainless steel pair tube
Floor: PVC floor



GJ-02 (标配)

上下罩: 钢板烤漆, 配亚克力灯饰
观光壁: 方形, 安全夹胶玻璃
装饰顶: 镜面不锈钢框架, 中间亚克力拱形喷绘顶板, 两侧筒灯点缀
轿壁: 发纹不锈钢
扶手: Φ38不锈钢单管
地板: PVC地板

GJ-02 (standard)

Car cover: Steel plate baking finish, acrylic lighting decoration
Observation wall: Square, Glue glass of safety clamp
Decoration roof: Mirror stainless steel framework, Intermediate acrylic arched spurs draws top plate, Two sides down lamp decoration
Car wall: Hairline stainless steel
Handrail: Φ38 stainless steel tube
Floor: PVC floor



GJ-03 (标配)

上下罩: 钢板烤漆
观光壁: 菱形, 安全夹胶玻璃
装饰顶: 镜面不锈钢框架, 两侧亚克力灯饰, 中间多层次透光板。
轿壁: 发纹不锈钢
扶手: Φ38不锈钢管
地板: PVC地板

GJ-03 (standard)

Car cover: Steel plate baking finish
Observation wall: Diamond, Glue glass of safety clamp
Decoration roof: Mirror stainless steel framework, acrylic lighting decoration on both sides, multi-layer light-emitting board in the middle
Car wall: Hairline stainless steel
Handrail: Φ38 stainless steel tube
Floor: PVC floor

观光电梯 Observation Elevator

韦伯系列观光电梯利用国外先进的电梯控制技术,通过吸收、转化、提升而生产出的系列新型全电脑、模块化控制的变频调速电梯。其先进的变频(VVVF)驱动和全电脑控制技术,融合了数据网络化系统和模块化结构,使系统控制更加精确、高效、灵活、合理,并利用了最有效的自检程序,使电梯能淋漓尽致地发挥其功效,将电梯的性能提高到了一个更高的水平,真真切切的满足乘客的要求。

韦伯系列观光电梯其轿厢设计灵活多样,能与多种建筑物融为一体,尤其适合日益增长的中高层建筑的需求。是宾馆、饭店、办公大楼、商住楼、娱乐中心、商场等场所最为理想的选择。

韦伯以自己的品质保证:一个优秀的电梯系统会使您的建筑生机勃勃,使您更享与众不同的尊贵和豪华。

"WEBSTAR" serial Observation lift utilizes the advanced lift control technology from the overseas countries. We absorb, transform, and improve this technology, and manufacture series of late-model fully computerized and modularized control VVVF passenger lift. Its advanced variable frequency (VVVF) drive and fully computer control technology merges with the data net system and modularized structure. It brings about a more precise, efficient, flexible and reasonable systematic control. It also adopts the most effective self-inspection program to give a full play of the lift functions. It moves the lift performance to a higher level. It truly satisfies the passenger requirements.

"WEBSTAR" serial Observation lift has flexible and varied car design. It can integrate with multiple constructions into a whole. It is especially fit for the demands from the rapidly increasing from medium and high rise buildings. It is the most ideal choice for the guest-house, restaurant, office building, commercial and residential building, recreation center, shopping center etc.

"WEBSTAR" lift guarantees on behalf of its own quality, "an excellent lift system can bring full of vitality to your constructions. what is more, you can enjoy the extraordinary honor and luxury"

Construction Parameters 土建参数

观光电梯
Observation Elevator

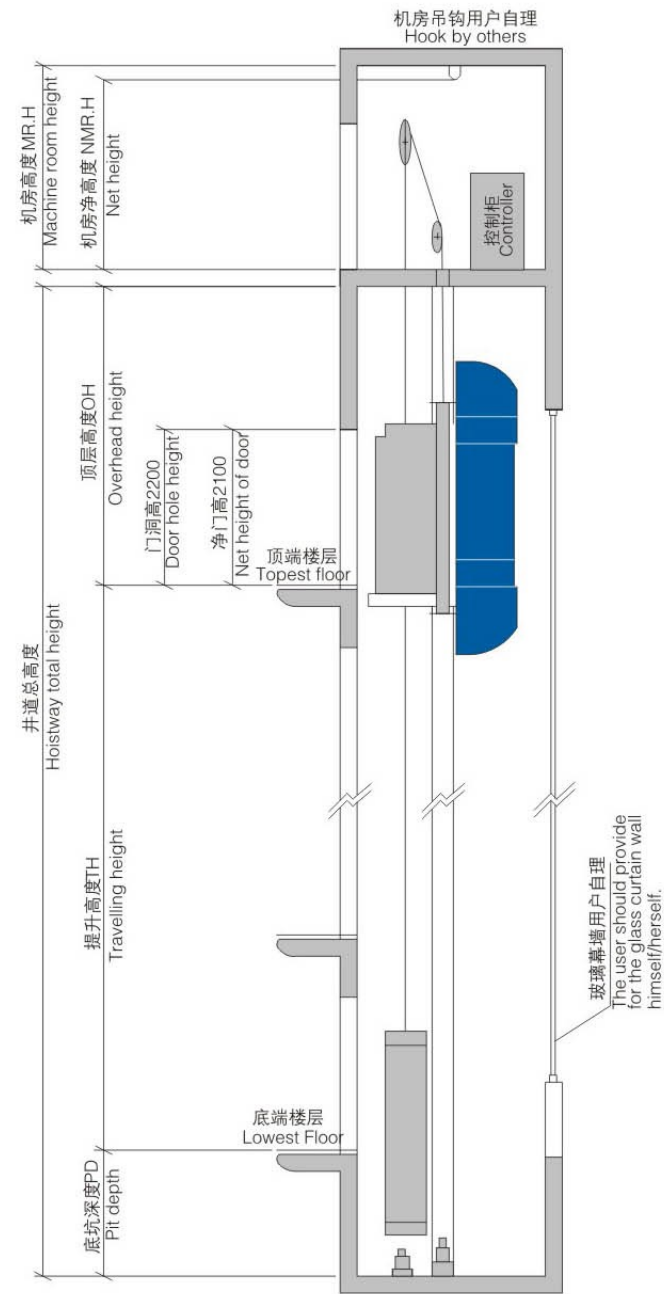

井道立面图
Hoistway section

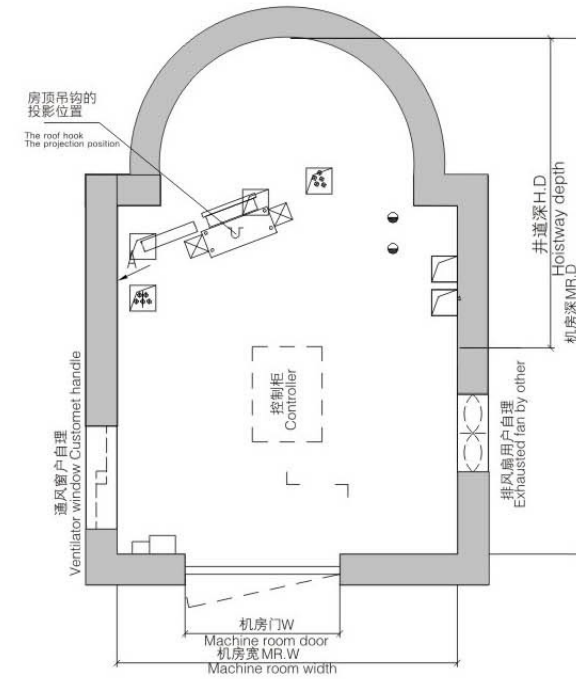

机房布置图
Machine room plan

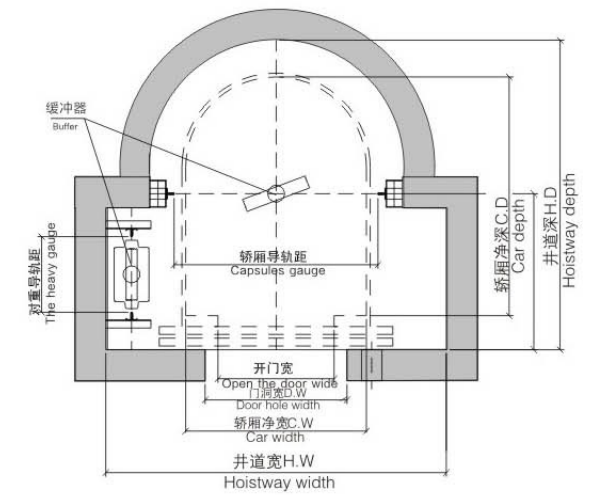

井道布置图
Hoistway plan

◎ 观光电梯 Observation Elevator

主参数 Main specifications	载重量(Kg) Loading capacity	800			1000			
	额定速度(m/s) Rated speed	1.0	1.5	1.75	1.0	1.5	1.75	2.0
开门尺寸(mm) Door opening size	800	800	800	900	900	900	900	
轿厢尺寸(mm) Car size	宽 Width	1100	1100	1100	1100	1100	1100	1100
	深 Depth	1900	1900	1900	2100	2100	2100	2100
井道尺寸(mm) Hoistway size	宽 Width	2200	2200	2200	2200	2200	2200	2200
	深 Depth	2400	2400	2400	2600	2600	2600	2600
顶层高度(mm) Top floor height	4500	4700	4900	4500	4700	4900	5000	
底坑深度(mm) Pit depth	1700	1800	1900	1700	1800	1900	2000	
最大提升高度(m) Max travelling height	50	75	90	80	75	90	100	

注：土建及参数表仅供参考。Note: Construction layout and parameters are for reference only.

病床电梯 Bed Elevator



病床电梯，不仅用于运送乘客，还因使用的特殊而对电梯的功用性能有着特殊和严格的要求。韦伯病床电梯，能精确地控制电梯的运行速度，运行平稳舒适。韦伯病床电梯注重人性化的设计，来充分优化轿厢结构，最大限度地满足客户的使用要求。为乘客营造一个宁静、淡雅的空间。

韦伯病床电梯以其独特的设计理念，创造与医院环境和谐统一，清洁明亮的空间，为乘客创造一个舒适的环境，为病人更增添几分康复的信心。

WEBSTAR bed lift not only used for carry passenger but also asked for high capability and demand. WEBSTAR bed lift can control the running speed accurately and placidly.

Furthest WEBSTAR bed lifts pay attention to human design, optimize the car frame, and furthest suffice passenger's needs. Make a quiet space for passengers. WEBSTAR bed lifts make a harmonious and lightful space with it, s special design, bring a comfortable circumstance for passenger, and good mood for patient.

Standard Configuration 标准配置

仅供参考，以实物为准
This is for reference only.
Please take actual products as criterion

病床电梯技术规格表
Bed lift technical specification table

目标市场 Target Market	医院及救援医疗机构 Hospital and medical aid institutions
控制系统 Control System	VVVF
曳引机 Traction machine	无齿轮 Gearless
门机 Door machine	VVVF 变频门机 VVVF Variable Frequency Door Motor
轿厢高度 Car height	标配: 2400mm 选配: 2500mm、2600mm
额定载重 (公斤) Rated Load(kg)	1000、1600
额定速度 (米/秒) Rated Speed(m/s)	1.0、1.5、1.6、1.75
最大提升高度 (米) Max.Travel Height	90
最大群控台数 Max.Car Group	8



残疾人专用操纵箱 (标配)
The handicapped special-purpose operation panel (optional)



吊 顶: CL-03一体式(标配)	Ceiling: CL-03 Integrated Ceiling(Standard)
操纵箱: COP-04	Operation panel: COP-04
轿 壁: 发纹不锈钢板	Car wall: Hairline stainless steel plate
轿 门: 发纹不锈钢板	Car door: Hairline stainless steel plate
地 板: PVC塑胶地板	Floor: PVC plastic cement floor

Construction Parameters 土建参数

病床电梯 Bed Elevator

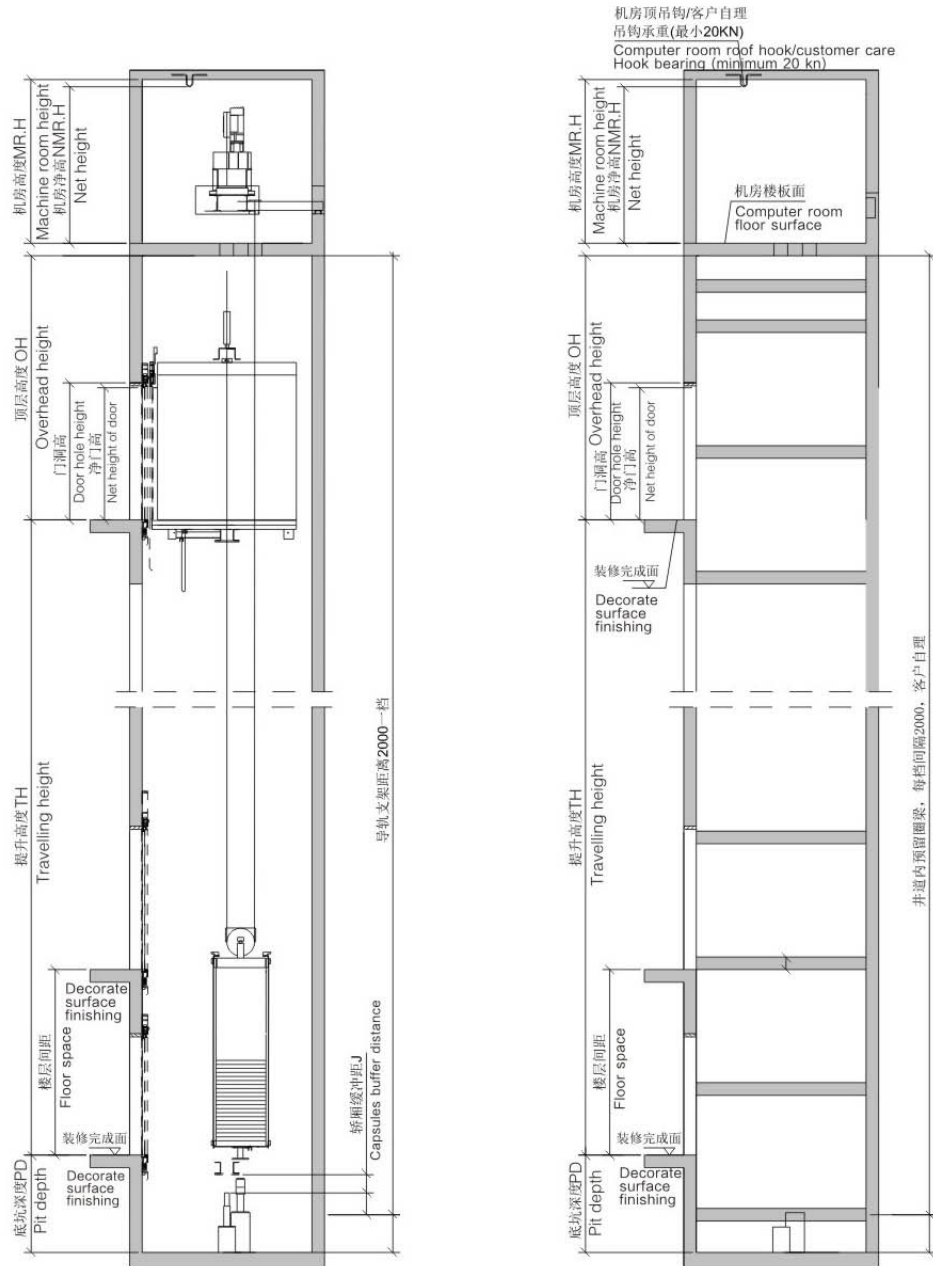

井道侧视图
Hoistway section

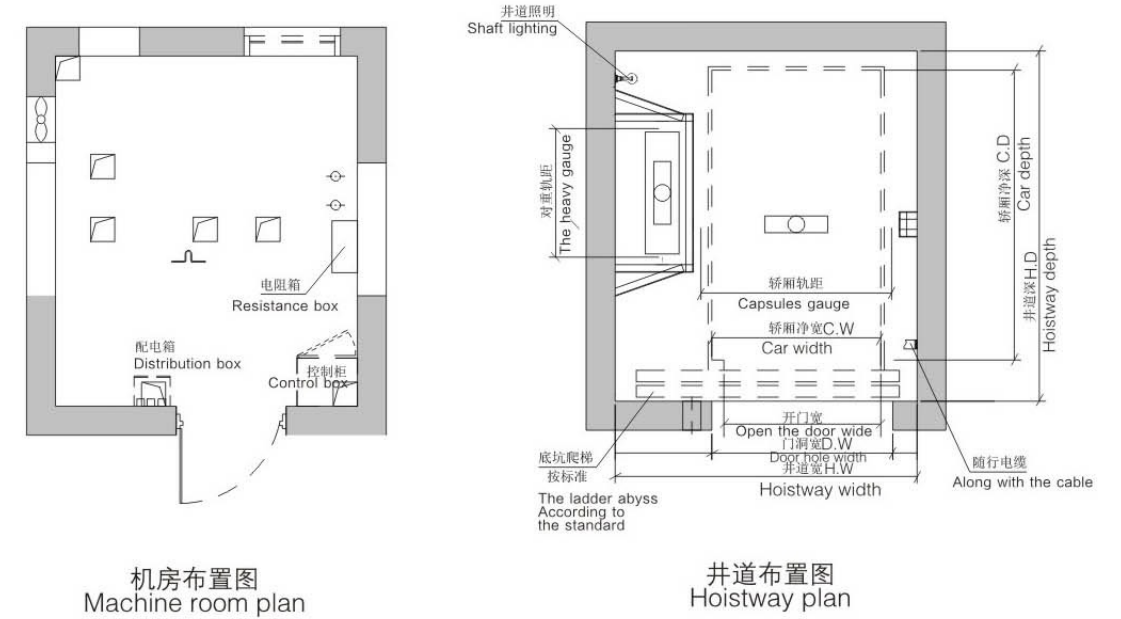

○病床电梯 Bed Elevator

主参数 Main specifications	载重量(Kg) Loading capacity	1000			1600		
	额定速度(m/s) Rated speed	1.0	1.5	1.75	1.0	1.5	1.75
开门尺寸(mm) Door opening size		1000	1000	1000	1300	1300	1300
轿厢尺寸(mm) Car size	宽 Width	1100	1100	1100	1400	1400	1400
	深 Depth	2100	2100	2100	2400	2400	2400
井道尺寸(mm) Hoistway size	宽 Width	2100	2100	2100	2500	2500	2500
	深 Depth	2500	2500	2500	2900	2900	2900
顶层高度(mm) Top floor height		4500	4600	4700	4500	4600	4700
底坑深度(mm) Pit depth		1500	1600	1700	1500	1600	1700
最大提升高度(m) Max. travelling height		50	75	90	50	75	90

注: 土建及参数表仅供参考。Note: Construction layout and parameters are for reference only.

Control Box 操纵箱

智能的操控体验，机敏调动每一个电梯零部件，确保高速运行、平稳停靠、安全上下。

The intelligent manipulation experience can alertly mobilize each elevator part, to guarantee the high-speed operation, stable stopping and safety up and down.



COP-02



COP-03



COP-04



COP-12



COP-13

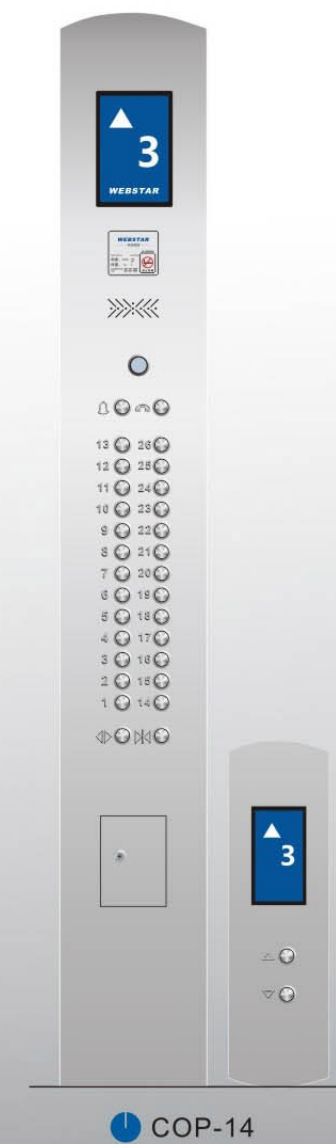

COP-14



One-piece Touch control Box

一体式操纵箱

可视化电子显示器、智能化梯层显示，每个按钮之间以精准的距离依次排开，一体式、液晶、多媒体多种选择，上下骑行中带来不一样的操纵感受。

With the visualized electronic display and intelligent elevator layer, it is arranged in succession with precious distance between each key. There are multiple options including one-piece, liquid crystal, and multi-media, to bring different manipulation experience of being lifted up and down

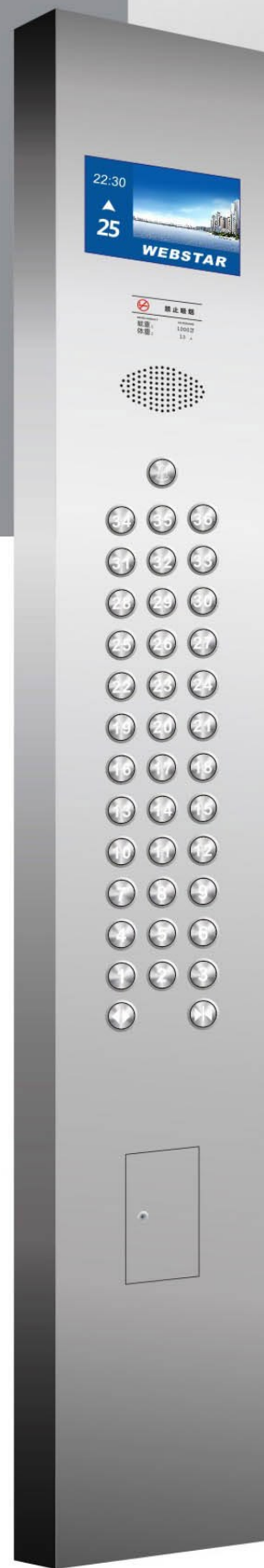

● COP-21



● COP-22

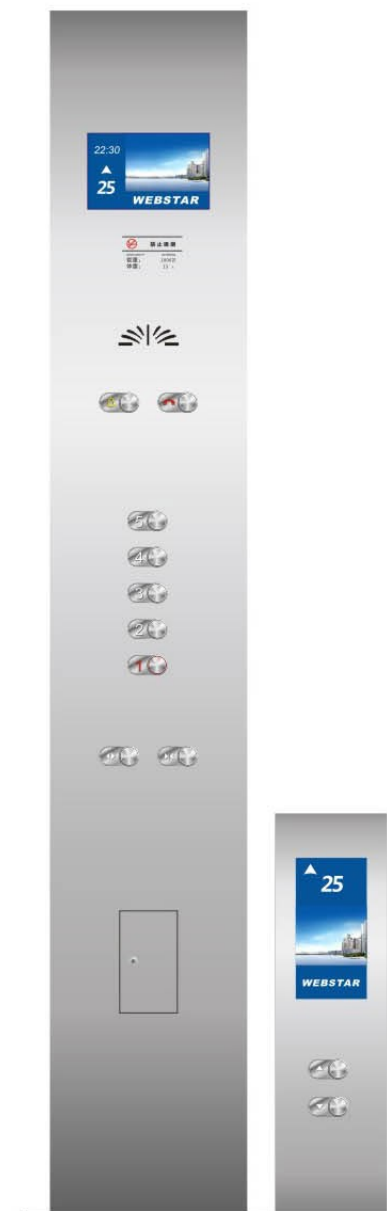

● COP-23



● COP-24

吊顶 Ceiling



CL-04(一体式)



CL-05(一体式)



CL-06(一体式)



CL-11



CL-12



CL-13

扶手 Handrail



FS-01



FS-02



FS-03



FS-01B



FS-02B



FS-03B

地板 Floor



PD-01



PD-02



PD-03



PD-04

喷塑色标 Plastic Jet Color Standard



KQ-01浅灰色 Light gray



KQ-02深灰色 Dark gray



KQ-03米黄色 Yellowish



KQ-04果绿色 Green





KQ-05浅蓝色 Light blue

<p>运输功能 Running Function</p>	<p>电梯变频驱动 VVVF drive</p>	<p>精确调整电动机转速,令电梯启动、运行、停止时得速度曲线平稳、圆滑,获得良好的舒适感。 Motor rotating speed can be precisely adjusted to get smooth speed curve in life start,travel and stop and gain the sound comfort.</p>
	<p>门机变频驱动 VVVF door running</p>	<p>精确调整电动机转速,使门机的开启、关闭更轻柔灵敏。 Motor rotating speed can be precisely adjusted to get the more gentle and sensitive door machine start/stop.</p>
	<p>独立运行 independent runing</p>	<p>通过动作开关,使电梯不响应外召,仅响应轿内指令。 The lift can not respond to outer calling,but only respond to the command inside the car through the action switch.</p>
	<p>自动不停站通过 Automatic pass without stop</p>	<p>当轿内挤满乘客或负载接近预定值,为保持最大运行效率,该轿厢将自动越过召唤层站。 When the car is crowded with the passengers or the load is closeto preset value,the car will automatically pass the calling landing in order to keep maximum travel efficiency.</p>
	<p>开门时间的自动调整 Automatically adjust door opening time</p>	<p>按照层站召唤或轿厢召唤的区别,自动调整保持开门时间。 Door-open time can be automatically adjusted according to the difference between landing calling or car calling.</p>
	<p>本层重新开门 peopen with hall call</p>	<p>关门途中,可以按本层站召唤按钮使门重新开启。 In the door shutting process,press reopen with hall call button can restart the door.</p>
<p>安全功能 safety function</p>	<p>光幕保护 Photocell protection</p>	<p>门开启或关闭期间,用覆盖整个门高度的红外光探测乘客和物体的门保护装置。 In the door open and shut period,infrared light that covers the whole door height is used to probe the door protection device of both the passenger and objects.</p>
	<p>指定停靠 Designated stop</p>	<p>由于某种原因,电梯在目的层无法开门,电梯将关门运行下一指定层楼。 If the lift cannot open the door in the destination floor out of some reason,the lift will close the door and travel to the next designated floor.</p>
	<p>超载停梯 Overload holding stop</p>	<p>轿厢超载时,鸣响蜂鸣器并停止于该层站。 When the car is overload,the buzzer rings and stops the lift in the same floor.</p>
	<p>防止失速内部计算机保护 Anti-stall timer protection</p>	<p>由于曳引钢丝绳打滑而无法正常运行时,电梯停止运行。 The lift stops operation due to slippery traction wire rope.</p>
	<p>启动保护控制 Start protection control</p>	<p>电梯启动后在指定的时间内,没有离开门区,电梯停止运行。 If the lift does not leave door zone within the designated time after it gets started,it will stop the operation.</p>
<p>人机界面 Human-machine interface</p>	<p>检修操作 Inspection operation</p>	<p>当进入检修状态时,轿厢以低速点动运行。 When the lift enters into inspection operation,the car travel at inching running.</p>
	<p>故障自诊断 Fault self-diagnosis</p>	<p>控制器可以录最新的62个故障,以便快速排除故障,迅速恢复电梯运行。 The controller can record 62 latest trouble so as to quickly remove the trouble and restore the lift operation.</p>
	<p>电梯门重复开关 Repested door closing</p>	<p>有时因阻碍或干扰,电梯未能关闭,电梯门会重复打开或关闭,直到杂物被清除。 If the lift can not close the door due to certain obstacle or interference,the lift will reopen or re-shut the door until sundries are eliminated</p>
	<p>上下越层及上下极限保护装置 Up/down over-run and final limit protection</p>	<p>该装置可有效的防止当电梯万一发生失控时的冲顶或撞底现象,使电梯更安全可靠。 The device can effectively prevent from the lift's surging to the top or knocking the bottom when it is out of the control. It results in the more safe and reliable lift travel.</p>
<p>节能功能 Energy saving</p>	<p>下行超速保护装置 Down over-speed protection device</p>	<p>当电梯下降运行的速度超过额定的1.2倍时,该装置自动切断控制电源,使电机停止运转以阻止电梯超速下行:如电梯继续超速下降,其速度超过额定速度的1.4倍时,安全钳动作,强制电梯停止运行,保证安全。 When the lift downs 1.2 times higher than the rated speed,this device will automatically cut off control mains,stop the motor running so as to stop lift down at over-speed,and the speed is 1.4 times higher than rated speed,safety tongs act to force the lift stop in order to ensure the safety.</p>
	<p>上行超速保护装置 Upward over-speed protection device</p>	<p>当电梯上行的速度超过额定速度的1.2倍时,该装置自动减速或制停。 When the lift ups 1.2 times higher than rated speed,the devicce will automatically decelerate or brake the lift.</p>
	<p>桥内及层站微动指令按钮 Micro-touch button for car call and hall call</p>	<p>桥内操纵箱指令按钮及层站召唤按钮采用新型微动型按钮。 Novver micro-touch button is used for operation panel command button in the car and landing calling button.</p>
<p>人机界面 Human-machine interface</p>	<p>桥内/方向指示 Floor and direction indicator inside car</p>	<p>桥内显示电梯所在层楼及当前运行方向。 The car shows the lift floor location and current travel direction.</p>
	<p>层站层楼、方向指示 Floor and direction indicator</p>	<p>层站显示电梯所在层楼及当前运行方向。 The landing shows the lift floor location and current travel direction.</p>
<p>节能功能 Energy saving</p>	<p>轿厢风扇/照明自动开关 Car ventilation,lighting automatic shut off</p>	<p>在规定的时间内没有召唤或指令信号,轿厢内的风扇和照明会自动关闭以节能。 If there is no calling or command signal within the stipulated time,the car fan and lighting will be automatically closed in order to save the energy.</p>
	<p>远程关闭 Remote shut-off</p>	<p>通过钥匙开关,电梯可以被召回到基站(服务完成后),并自动退出服务。 When the lift enters into emergency electric operation,the car travels at low speed inching running.</p>

标准功能 Standard Function

 <p>应急功能 Emergency function</p>	<p>应急照明 Emergency car lighting</p>	<p>停电时,自动打开桥内应急照明。 Emergency car lighting automatically activated once power failure.</p>
	<p>点动运行 Inching running</p>	<p>当进入紧急点动状态时,桥厢以低速点动运行。 When the lift enters into emergency electric operation,the car travels at low speed inching running.</p>
	<p>五方通话装置 Five way intercom</p>	<p>通话对讲机,可让桥内、桥顶、电梯机房、井道底坑、救援值班室之间通话。 Communication amid car,car top,lift machine room,well pit and rescue duty room through walkie-talkie.</p>
	<p>警铃 bell</p>	<p>紧急时,连续按下桥内操纵箱上的警铃按钮,安装于桥厢顶上的电铃会鸣响。 In emergency condition,if bell button above car operation panel is continuously pressed,electric bell rings on top of car.</p>
	<p>消防返回 Fire emergency return</p>	<p>启动基站指定救援层站停靠,站或监控屏上的钥匙开关,所有召唤均被取消,电梯立即驶往,并自动开门 If you start key switch in main landing or monitor screen ,all the callings will be canceled,the lift directly and immediately drives to the designated rescue landing automatically opens the door.</p>

选配功能 Optional Function

 <p>应急功能 Emergency function</p>	<p>停电应急平层 Leveling when power failure</p>	<p>正常电源断电时,充电式电池提供电梯电源,电梯驶往最近层站。 In normal power failure,the chargeable battery supplies the power.The lift drives to the nearest landing.</p>
 <p>运输功能 Running Function</p>	<p>防捣乱 Anti-nuisance</p>	<p>当电梯轻载时出现超过三个指令时,为避免不必要的停靠,桥厢内已登记的召唤将全部自动消除。 In the light load,when three more commands appear,in order to avoid the unnecessary parking,all the registered callings in the car will be canceled.</p>
	<p>提前开门 Open the door in advance</p>	<p>电梯减速进入开门区域,自动开门,提高运行效率。 When the lift decelerates and enters into door open zone,it automatically opens the door to enhance the travel efficiency.</p>
	<p>直接停靠 Direct parking</p>	<p>完全根据距离原则,平层无爬行,大大提高了运行效率/ It completely accords with distance principle with no crawling in the leveling.It greatly enhance the travel efficiency.</p>
	<p>群控功能 Group control function</p>	<p>用于三台或三台以上同型号电梯成组控制时使用,使群控能自己选择最合适的应答,避免电梯间重复停梯,缩短乘客候梯时间,提高运行效率。 When three or more same model lift groups are controlled in use,the lift group can automatically choose the most appropriate response.It avoids the repeated lift parking, reduces the passengers' waiting time and increase the travel efficiency.</p>
	<p>并联功能 Duplex control</p>	<p>用于两台同型号电梯,通过电脑的调度来同意响应召唤信号,以最大限度地减小乘客的候梯时间,以提高运行效率。 Two sets model lifts can unanimously respond the calling signal through the computer dispatch.In this way,it reduces the passengers' waiting time to the greatest extent and enhances the travel efficiency as well.</p>
	<p>上班高峰服务 On-duty peak service</p>	<p>在预定上班时间内,基站向上的运输特别繁忙时,向基站不断派梯以件扫上班高峰需要。 Within the preset on-duty time,upward transport from the home landing is extremely busy.The lifts are continuously dispatched to the home landing in order to satisfy on-duty peak service.</p>
	<p>下班高峰期 Off-duty peak service</p>	<p>在预定下班时间内,向顶层派梯满足下班时间高峰需求。 Within the preset off-duty period,the lifts are continuously dispatched to top floor in order to satisfy off-duty peak service.</p>
	<p>开门时间延长 Door open time extending</p>	<p>按桥厢内的专用按钮,可使门在一段时间内保持开门状态。 Press special button in the car,the lift door keeps open for certain period of time.</p>
<p>桥厢到站钟 Car arrival gong</p>	<p>装于桥厢顶的电子钟的钟声告知候梯的乘客已到站。 Arrival tong in the car top announce that the passengers arrive.</p>	
 <p>人机界面 Human-machine interface</p>	<p>语音报站 Voice announcer</p>	<p>在正常运动到站的情况下,利用语音装置告知乘客有关信息。 When the lift normally arrives,voice announcer informs the passengers about the relevant information.</p>
	<p>桥厢副操纵箱 Car assistant operation box</p>	<p>用于大载重量电梯或候梯人群稠密大楼中的电梯,一让桥厢内更多的乘客方便使用。 It is used in the large loading weight lifts or lifts with crowded passengers so that more and more passengers can use the car.</p>
	<p>残疾人操纵箱 Operation box for the handicapped</p>	<p>便于桥厢内坐轮椅的乘客及视觉障碍的乘客方便使用。 It is convenient for the wheelchair passengers and those who have vision problems.</p>
	<p>智能召唤服务 Intelligent calling service</p>	<p>通过专用的智能输入设备,可使桥厢指令或厅外召唤锁定或接通。 The car command or hoist-way calling can be locked or connected through special intelligent input.</p>
	<p>IC卡控制功能 IC card controlfunction</p>	<p>所有(部分)层站需经授权,方可通过IC卡输入桥厢指令运行电梯。 All(partial) landings can only input commands through IC card after the authorization.</p>
 <p>监控功能 Monitor function</p>	<p>远程监控 Remote monitor</p>	<p>通过调制解调器和电话,可实现电梯的远程监控,便于厂家和服务单位即使的了解每台电梯的运行状况,以便及时做出相应措施。 The lift long-distance monitor and control can be fulfilled through modern and telephone.It is convenient for the factories and service units to timely know the travel conditions of every lift and promptly take the corresponding measures.</p>
	<p>远程控制 Remote control</p>	<p>通过操作监控屏(可选择),可使电梯按指定的需要做独立运行。 The lift can have independent travel according to the specific requirements through operation monitor screen(optional).</p>
	<p>桥内摄像功能 Camera function in the car</p>	<p>摄像头装于桥厢内监视桥内情况。 The camera is installed in the car to monitor the car condition.</p>



科技启迪上下,专业保障安全。

Enlightened by technology,
Profession guarantees safety